



a xylem brand



a xylem brand

Installation instructions

UA 55 UA 130 UA-SO

Sensor extension

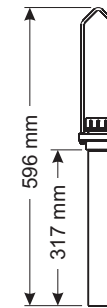

UA 55

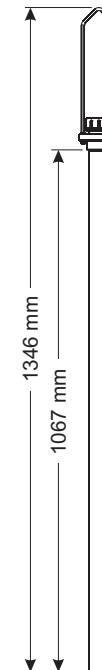

UA 130

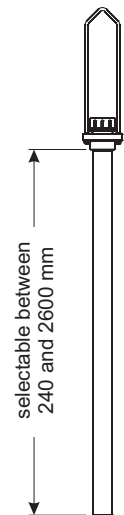

UA-SO

Model	Order no.
UA 55	109 260Y
UA 130	109 261Y
UA-SO	109 263VY

1725 Brannum Lane
 Yellow Springs, Ohio 45387 USA
 +1 937-767-7241
 800-765-4974 (US)
 FAX (937) 767-1058
 Email: environmental@ysi.com
 Internet: www.ysi.com

Installing the sensor

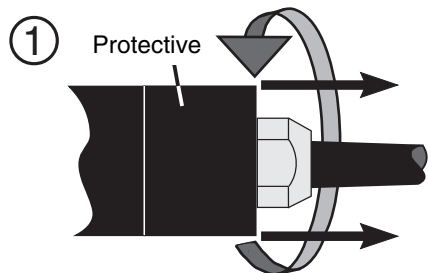

Unscrew the protection ring from the sensor and take it off the sensor cable.

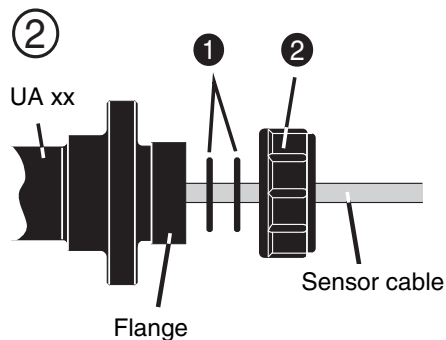

Push the sensor cable through the sensor extension from the opposite side so that the cable end protrudes from the flange a little bit.

Thread both O-rings (pos. 1) and the coupling ring (pos. 2) on the cable end.

Then pull the sensor cable through to the end. While doing so, hold the coupling ring and O-rings near the flange of the sensor extension.

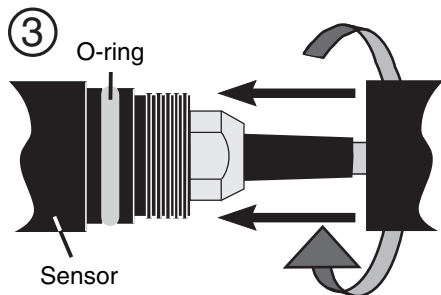

Lubricate the O-ring near the sensor with the grease provided. Then screw the sensor extension on the sensor.

Replacement parts

Description	Model	Order no.
Sealing set for sensor extension, including:	UA-DS	109 265Y
– Split disk		
– Sealing plug		
– Split pressure ring		
– O-rings (2 pieces)		
– O-ring grease		

Technical data

Allowed temperature range

-20 ... 60 °C (-4 ... 140 °F)

Allowed pH range

4 ... 12

Materials

Shaft	PVC
Coupling ring	PE
Sealing set parts:	
– Split disk	PPO
– Split pressure ring	PF 51
– Sealing plug	NBR
– O-rings	FPM
Electrode handle	Stainless steel 1.4571 (V ⁴ A)
Nuts. Washers	Stainless steel 1.4301 (V2A)

Pressure resistance

0.5 bar (5 x 10⁴ Pa)

The sensor extension meets the requirements according to article 3(3) of the directive, 97/23/EC ("pressure equipment directive").

Length (without electrode handle)

UA 55	317 mm
UA 130	1067 mm
UA-SO	selectable between 240 mm ... 2600 mm (see page 1)

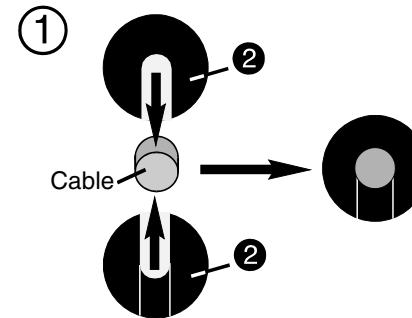
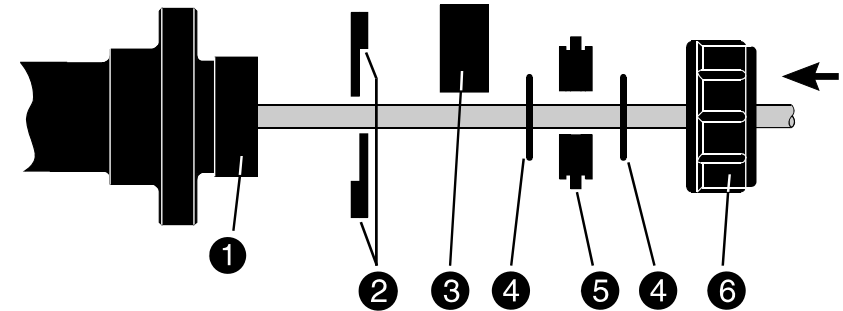

Assemble both halves of the split disk (pos. 2) around the sensor cable.

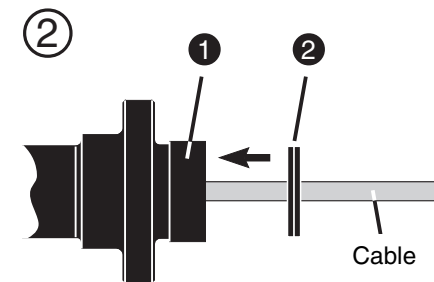

Insert the assembled disk (pos. 2) in the flange (pos. 1).

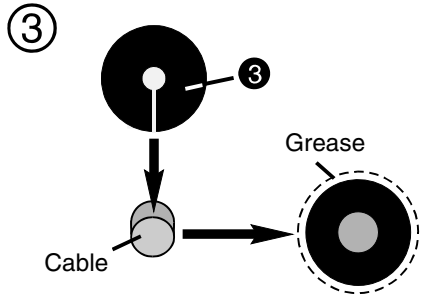

Put the sealing plug (pos. 3) on the sensor cable and grease it on the outside. Then press the sealing plug all the way into the flange.

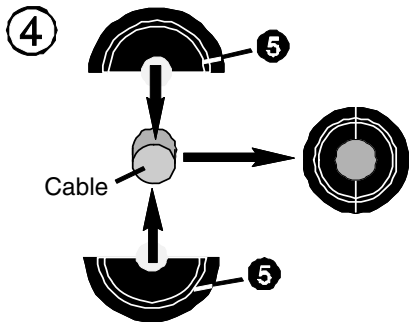

Assemble both halves of the split pressure ring (pos. 5) between the two O-rings around the sensor cable and fix them with the O-rings.

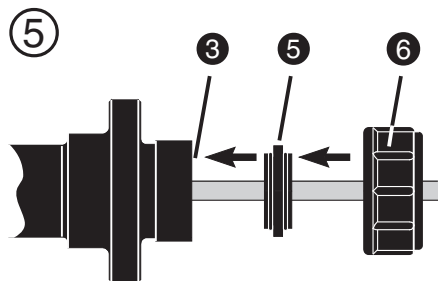
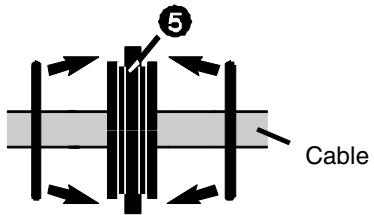

Push the assembled pressure ring (pos. 5) towards the sealing plug (pos. 3) in the flange.

Press the sensor cable somewhat (approx. 1 cm) into the flange and screw on the coupling ring (pos. 6) hand-tight.

Mounting the electrode handle

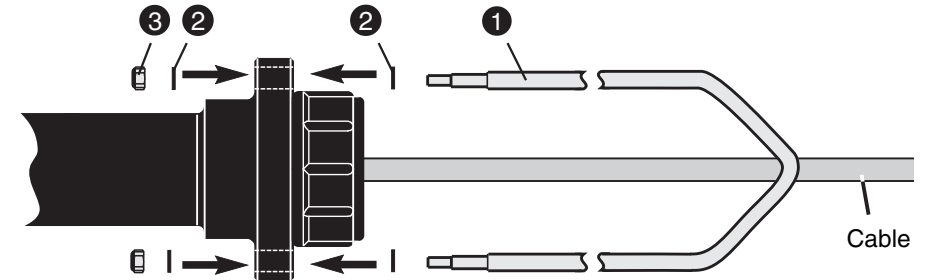

Put the handle (pos. 1) through the flange borings with the washers (pos. 2) and screw it tight with the washers and nuts (pos. 3).

Dismantling the sealing plug for sensor replacement

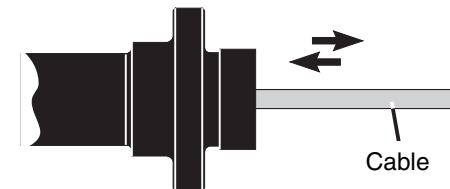

Pull the sensor cable somewhat out of the flange and press it in again. Repeat this until the sealing plug (black rubber) can be grasped.

Use a pointy object to help the sealing plug move out as necessary.